

NOTE: 1.  
 1. ALL MATERIALS EXCEPT BOLTS, GRATED TREADS, GRATED LANDINGS AND TO BE POWDER-COAT PAINTED BLACK.  
 2. ALL CONNECTIONS TO BE WELDED EXCEPT WHERE SECTIONS TO BE BOLTED TOGETHER AND BOLTED TO CONCRETE FOUNDATIONS AND LANDINGS AS SHOWN ON STAIR SECTIONS

3. STAIR SECTION

A2.2 | 1/4"=1'-0"

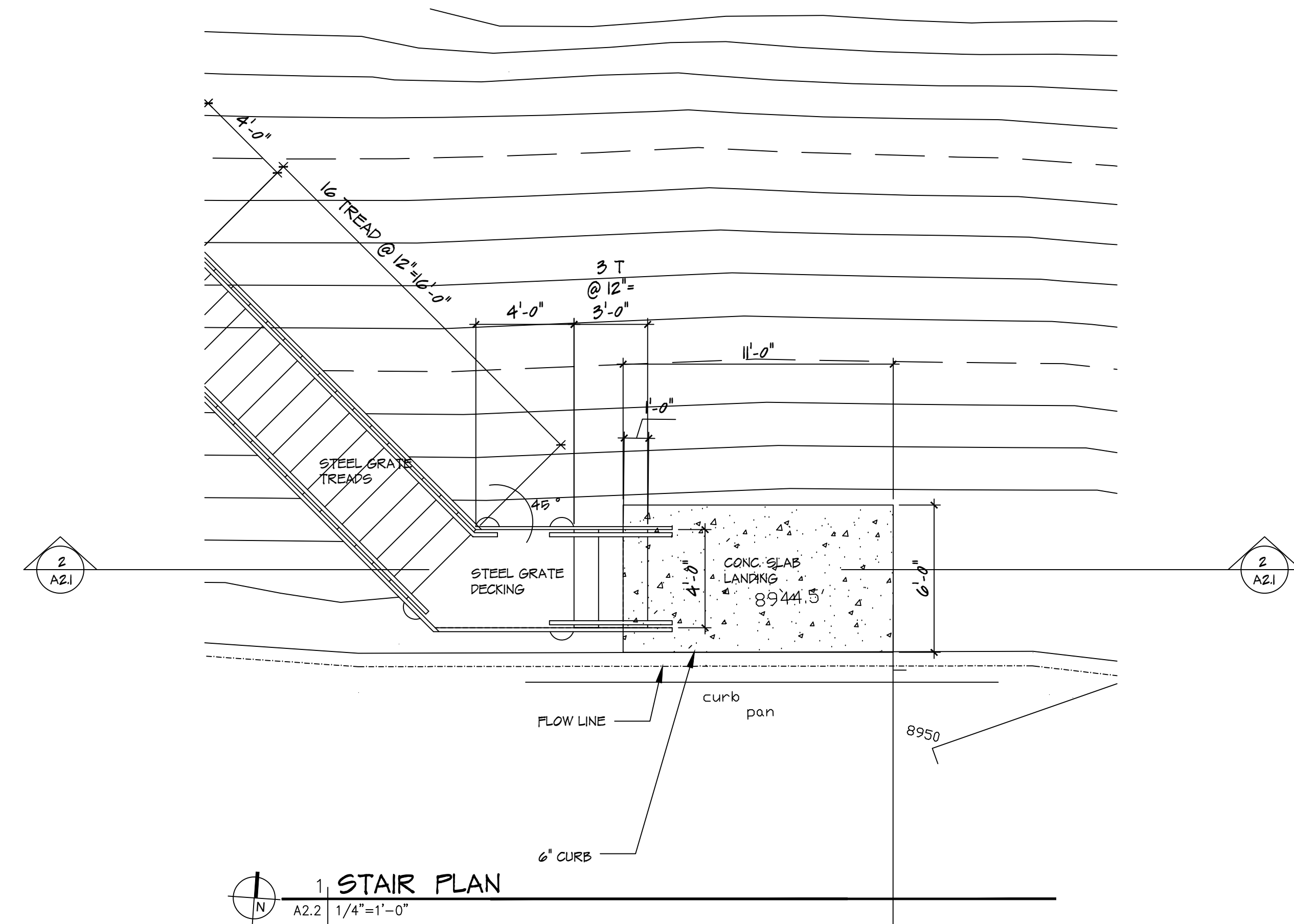

1. STAIR PLAN

A2.2 | 1/4"=1'-0"

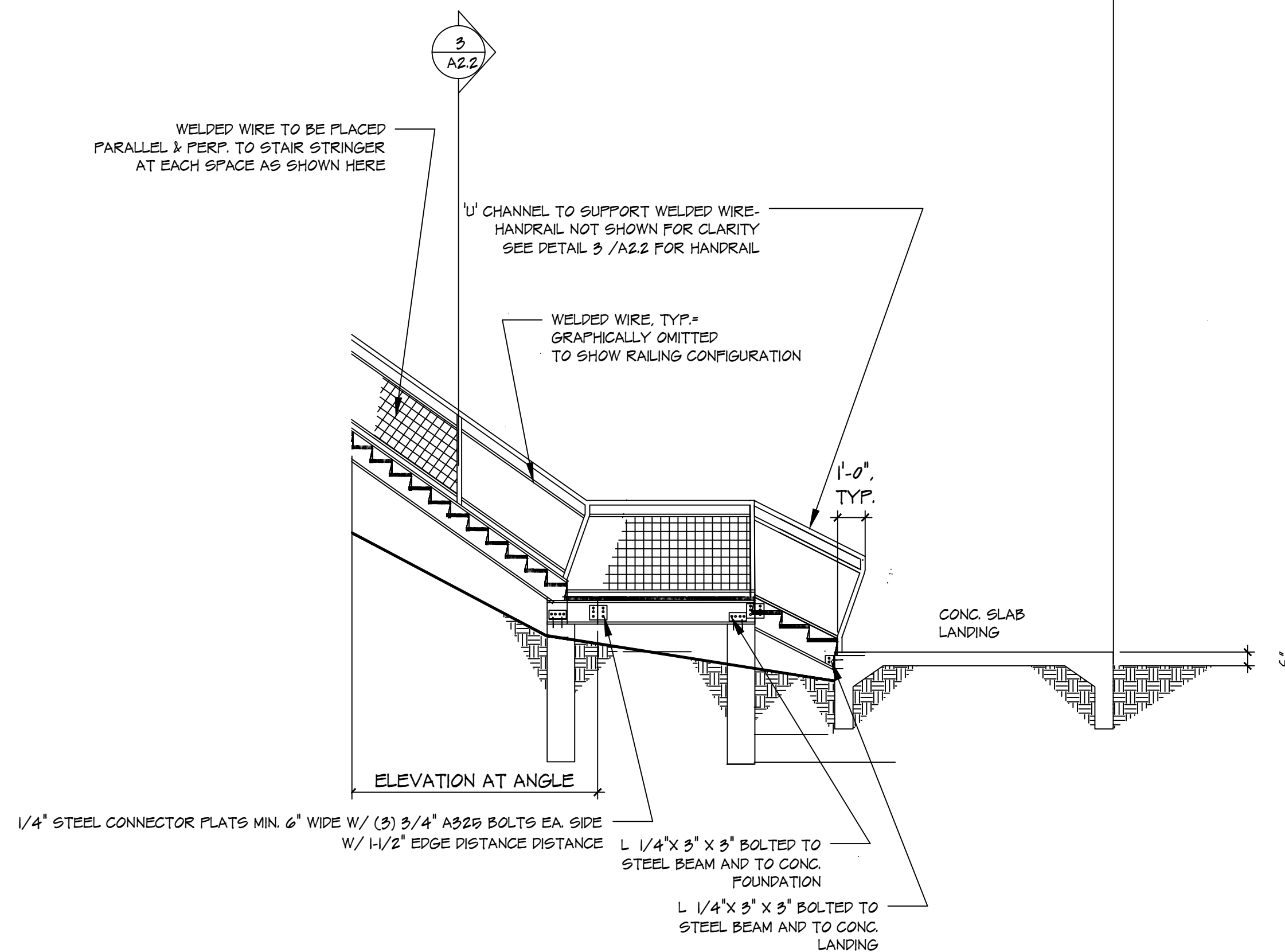

2. STAIR SECTION

A2.2 | 1/4"=1'-0"

LOOK  
 architecture llc  
 1074 S. ALKIRE ST.  
 LAKEWOOD, CO 80228  
 720-302-3952  
 lookarch.morrison@gmail.com

THIS DOCUMENT IS THE PROPERTY OF LOOK ARCHITECTURE AND THE IDEAS OR DRAWINGS PRESENTED HERE SHALL NOT BE USED WITHOUT THE SPECIFIC WRITTEN CONSENT OF LOOK ARCHITECTURE

GILPIN SCHOOL STAIRS  
 10595 CO HWY 119  
 BLACK HAWK, CO 80422

Project: STAIRS  
 Drawn by: RGL  
 Checked by: RGL  
 REVISIONS:

REVISIONS:

TO Client: 11-21-17  
 Submit for Permit:  
 for Construction Set:

Sheet Contents:  
 STAIR SECTION  
 DETAILS

DRAWINGS ARE NOT TO BE SCALED. ANY UNCLEAR OR CONFLICTING DIMENSIONS, DETAILS OR CONDITIONS ARE TO BE CLARIFIED WITH THE ARCHITECT / DESIGNER PRIOR TO CONSTRUCTION OR FABRICATION.  
 Sheet:

A2.2